

**Mill Saddle Oiler Detail**

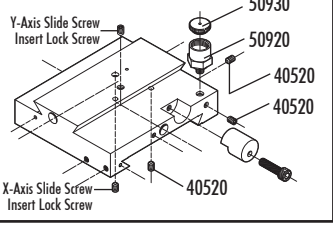

**Saddle Nut Assembly**

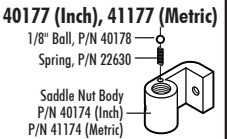

# Sherline Manual Model 5800/5810 NexGen Vertical Mill

NOTE: Where different, Inch part number is given first, followed by Metric part number.

**Exploded View and Part Numbers**

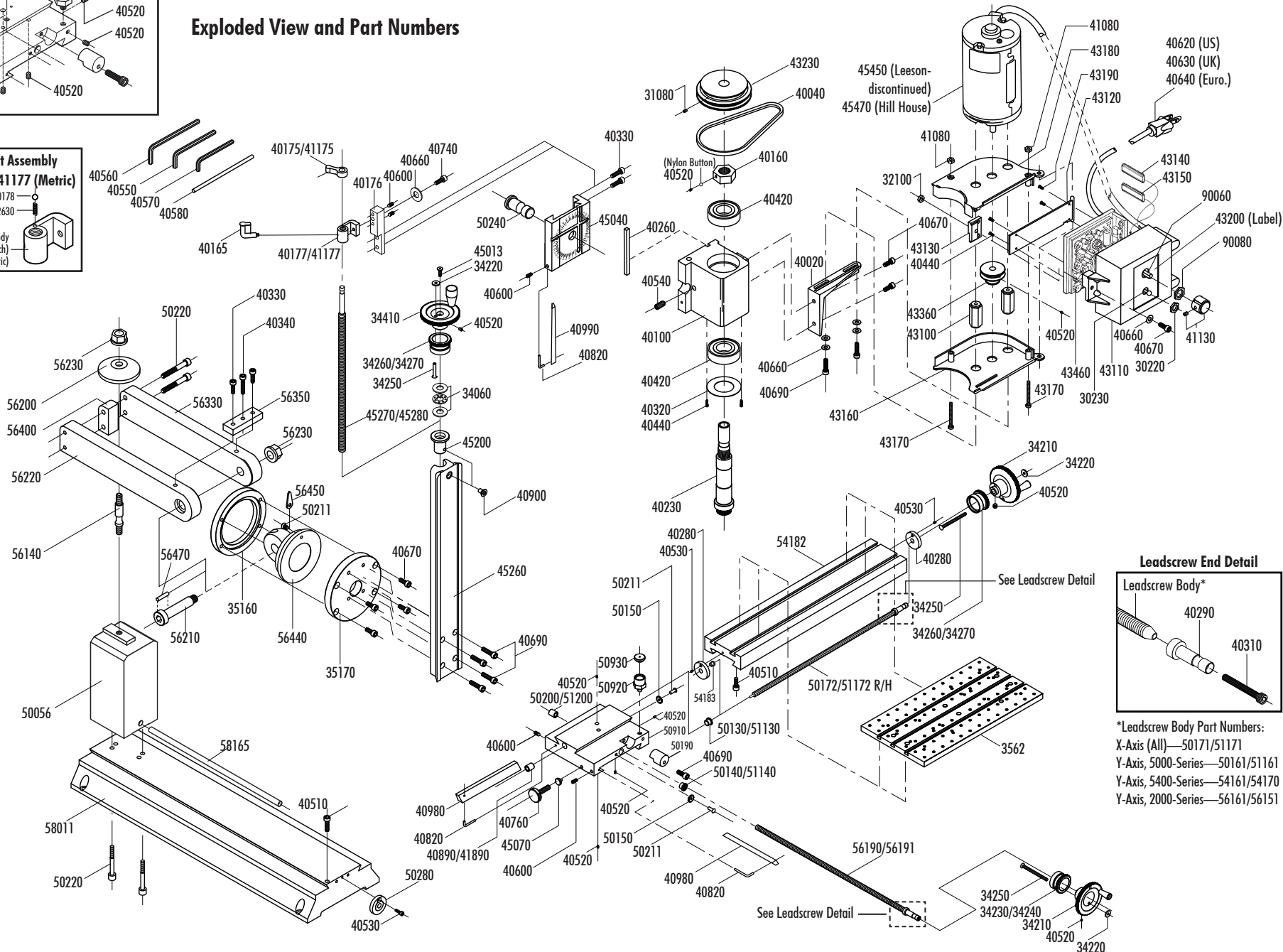

**Leadscrew End Detail**

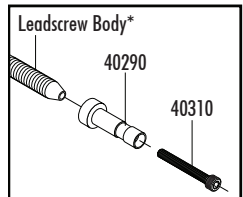

\*Leadscrew Body Part Numbers:  
X-Axis (All)—50171/51171  
Y-Axis, 5000-Series—50161/51161  
Y-Axis, 5400-Series—54161/54170  
Y-Axis, 2000-Series—56161/56151