

Sherline 4400 Lathe Exploded View and Part Numbers

NOTE: Where different, Inch part number is given first, followed by Metric part number.

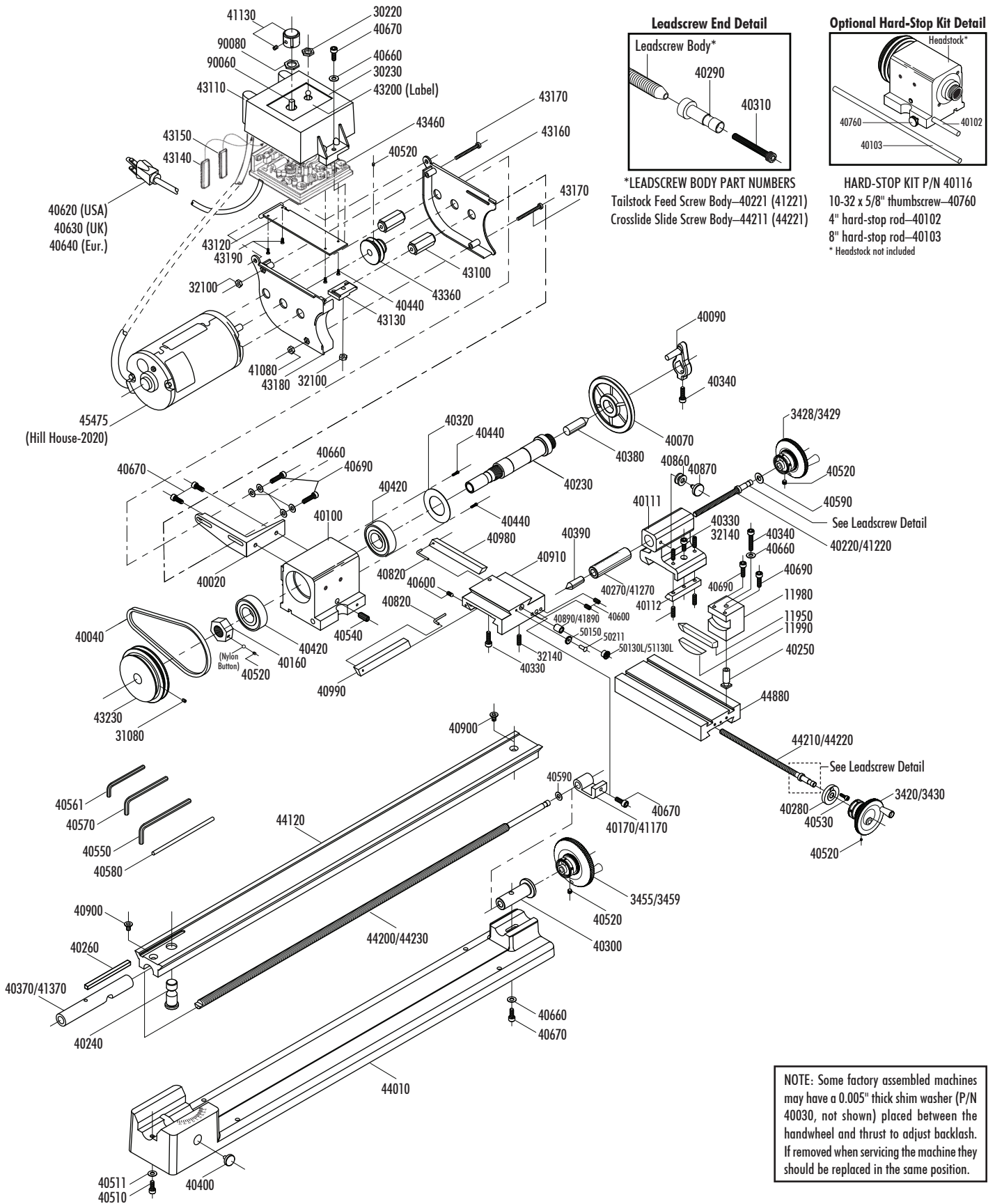

NOTE: Some factory assembled machines may have a 0.005" thick shim washer (P/N 40030, not shown) placed between the handwheel and thrust to adjust backlash. If removed when servicing the machine they should be replaced in the same position.